



Gear slotting fins provide perfect contact between fins and the conductivity panels to ensure the best heat transfer.

Weather fastness surface treatment provides good anti-corrosion, anti-rust for serious outdoor environment.



IP67 Rating, built-in respirator to adjust temperature difference to prevent from glass atomization.

Specifications

Electrical

MeanWell driver: 1xHLG-320-36A
Input Voltage: 100-240VAC
227VAC for North America only
Frequency: 47-63Hz
Power Consumption: \sim 320 watts
PF (Power Factor) > 0.95
Input Current (Amps) 1.65
Input Voltage (V) 230
Output Voltage (V) 36
Electrical outlet: Region appropriate

Color/Materials

Light Unit Body Material:
Black high quality Aluminum housing
with Tempered Glass Cover.

Cords

Power extension cord with waterproof
connector from light unit to power
box: Total 118" (3m)
Power Cord: 59" (1.5m)

Dimensions

Length: 10.6" (270mm)
Width: 12.6" (320mm)
Height: 10.8" (275mm)

Weight

Light Unit Weight: 10.6 lbs (4.8kg)
Power Supply Weight: 6.6 lbs (3kg)

Dimensions

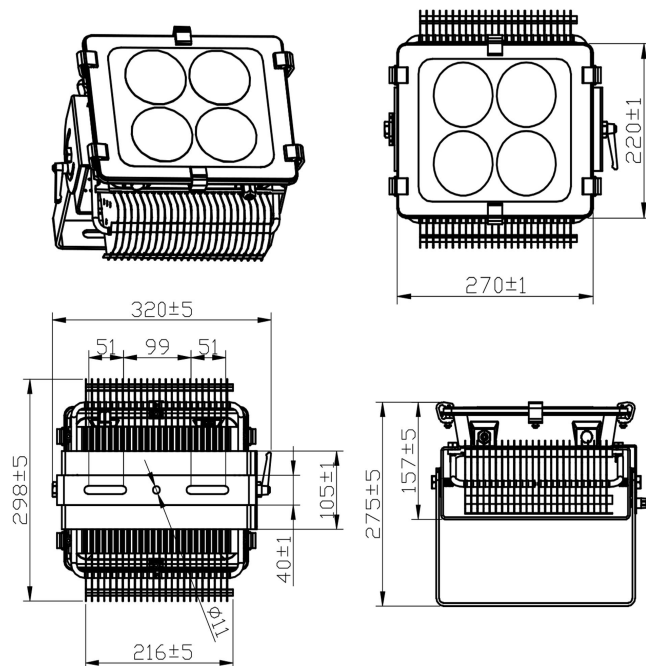

Light Source

Features

- Mechanical Dimensions: 28.0x28.0x1.4(mm)
- Package Structure: Copper Base Chip on Board
- CRI(Ra): 90Min.
- Thermal Resistance: 0.32C/W
- RoHS compliant
- Better die arrangement for optics
- Wide range of luminous flux and high efficacy

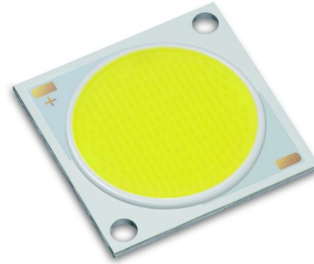

LEDs

4pcs 80 watts COB LEDs

LEDs Make Up

Matrix chip containing 80pcs of 3 watt LEDs.

LED make up will depend on Kelvin temperature used.

Lens Options

Aluminum Reflection Cup: 15/30/60 degree

15degree

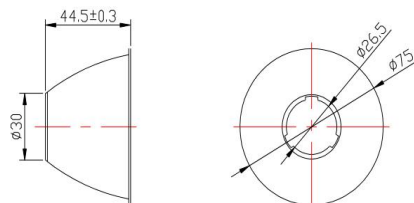

30degree

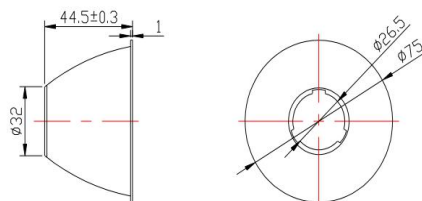

60degree

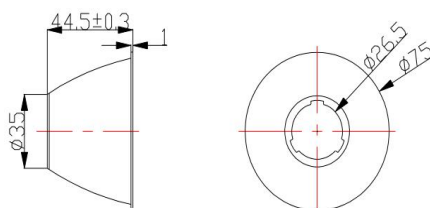

Package Dimensions / Weight

Length: 15.75" (400mm)

Width: 15.75" (400mm)

Height: 10.24" (260mm)

Package Weight: 22 lbs (10kg)

Package V.W.: 19.8 lbs (9kg)

